

TORO®

# EAGLE™ PLUS CONTROLLER



Eagle™ Plus controller has taken internet-based Central Control and ET-Adjustment to a new level. The Eagle Plus provides greater functionality on a more intuitive interface to equip the user with the tools necessary to maximize irrigation efficiency and water savings. Designed with an ultra-fast micro processor, the Eagle Plus enhances “real time” irrigation control. The Eagle Plus comes in a variety of configurations, including multiple enclosure options.

## FEATURES & BENEFITS

### Convenient Mobile Access

When connected to iCentral™, the free ProMax™ Connect app offers irrigation managers access to Eagle Plus controllers from anywhere, anytime

### More Connectivity

Wireless cellular communications. Faster “real time” internet access to iCentral Expanded text message Smart Alerts™

### More Configurations

Up to 48 stations conventional configuration and 200 stations in 2-Wire configuration. Up to 16 programs (8 for conventional and 16 for 2-Wire)

### Enhanced User Interface

Intuitive operation with multi-line LCD backlit display and simple multi-function input knob, plus more diagnostic tools

### iCentral Compatible for Full Internet Control

Connect and manage irrigation remotely through iCentral and its capabilities

### Flow Sensing and Control

Monitors system flow and responds to upper, lower, unscheduled and no flow conditions

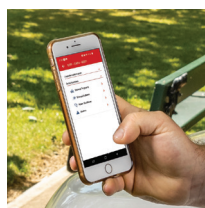

## Notable Features

- ✓ Available stations: 8, 16, 24, 32, 40, 48 conventional & 200 with 2-wire module
- ✓ Plastic wall mount available stations: 8, 16, 24, 32, 40 Conventional & 200 with 2-Wire module
- ✓ 8 programs with conventional and 16 program with 2-wire
- ✓ 8 start times per program for both conventional and 2-wire programs
- ✓ NVM (Non Volatile Memory) – No batteries required
- ✓ ET-based scheduling with various options
- ✓ Stainless steel enclosures and pedestals
- ✓ Self diagnostic and monitoring
- ✓ Flow sensing
- ✓ Cycle & soak
- ✓ Odd/Even day watering
- ✓ Rain sensor input
- ✓ Lightning/surge protection is standard
- ✓ No central software required

## iCentral™ with Eagle™ Plus Features

- ✓ Multi-level Auto Scheduler options maximize water savings
- ✓ ET calculations based upon Irrigation Association accepted standards
- ✓ ET scheduling utilizes industry accepted water budget methodology
- ✓ 24/7 365 days ET synchronization with ZipET™
- ✓ Secured wireless two-way communication
- ✓ Flow reports, daily ET information, built-in performance tools
- ✓ Smart Alerts™ Provide
  - Automated system alerts via email or text messaging
  - Automatic or manual rain shut off alerts
  - Automatic field wire fault protection and detection alerts

## Models

Model	Description
EGP8-PLAST	8-station expandable to 40 stations, plastic wall mount
EGP8	8-station expandable to 48 stations, coated steel wall mount
EGP8-S	8-station expandable to 48 stations, stainless steel wall mount
EGP8-SPED	8-station expandable to 48 stations, stainless steel security pedestal*
EGP8-PSB	8-station expandable to 48 stations, VIT Strong Box stainless steel security pedestal*
EGP8-PPED	8-station expandable to 48 stations, plastic pedestal
EGP8-OPB	8-station expansion module
EGP-TW-PLAST	2-wire, plastic wall mount
EGP-TW	2-wire, coated steel wall mount
EGP-TW-S	2-wire, stainless steel wall mount
EGP-TW-SPED	2-wire, stainless steel security pedestal*
EGP-TW-PSB	2-wire, VIT Strong Box stainless steel security pedestal*
EGP-TW-PPED	2-wire, plastic pedestal
5Y-EXT-WARRANTY	5 Year Extended Warranty

\*All SPED and PSB controllers are built to order in Riverside, CA.  
Please allow up to 10 days for delivery

## SPECIFICATIONS

### Electrical

- Input power required: 120 VAC  $\pm$  10%, 50/60 Hz
- Output power required: 24 VAC  $\pm$  10%, 50/60 Hz, 50 VA
- Total max load: 1.5 A @ 24 VAC, .5A @ 24 VAC per station
- PLAST input power required: 115 VAC  $\pm$  10%, 50/60 Hz
- PLAST total max load: 1.3A @ 24 VAC, .5A @ 24 VAC per station
- UL, CUL, and FCC approved

### Dimensions

- Wall Mount: H:10¾", W:9¾", D:5¾"
- SPED: H:35", W:16", D:14"
- PSB: H:38", W:16", D:15.5"
- PPED: H: 35", W: 16", D: 14"
- PLAST H: 15.3", W:15.5", D:6.4"

### Operating Specifications

- Operational Temp: 14° F to 140° F (-10° C to 60° C)
- Storage Temp: -22° F to 149° F (-30° C to 65° C)

## Commercial-Grade Enclosures

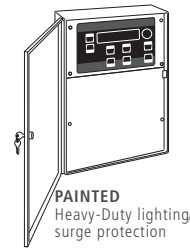

**PAINTED**  
Heavy-Duty lighting/  
surge protection

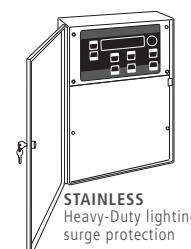

**STAINLESS**  
Heavy-Duty lighting/  
surge protection

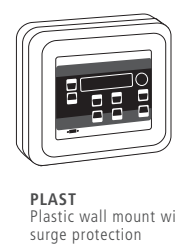

**PLAST**  
Plastic wall mount with  
surge protection

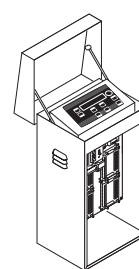

**SPED**  
14 gauge stainless  
steel security pedestal  
with surge protection

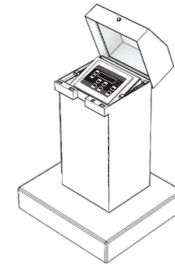

**PSB**  
16 gauge stainless  
steel security pedestal  
with surge protection

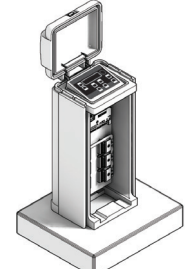

**PPED**  
Plastic pedestal  
with surge protection

## Optional Accessories

Model	Description
EGP-ICENTRAL	Eagle Plus Cellular communication kit with 60-months of iCentral service
EGP-ICENTRAL-P	Eagle Plus Cellular communication kit with 60-months of iCentral service, for plastic cabinets
EGP-ETHER	Eagle Plus Ethernet communication kit with 60-months of iCentral service
RMI-ISVC-5Y	Additional 60-months of iCentral service, for Cellular
RMI-ISVCETHR-5Y	Additional 60-months of iCentral service, for Ethernet
PMRKIT	Permanent mount receiver kit for use with ProMax™ remote
PMRKIT-P	Permanent mount receiver kit for use with ProMax™ remote, for plastic cabinets

## TWO-WIRE LAYOUTS

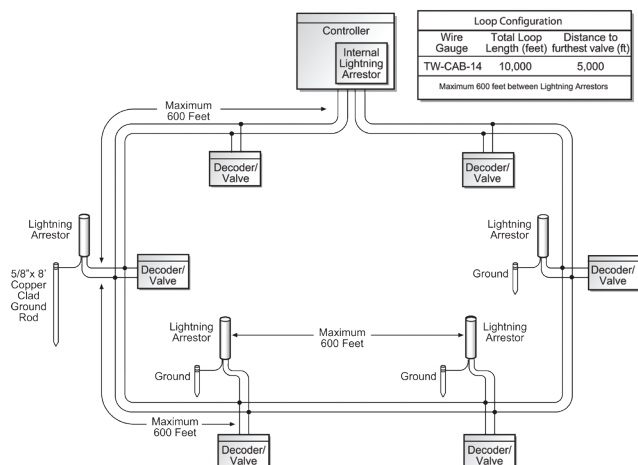

**Loop Configuration**

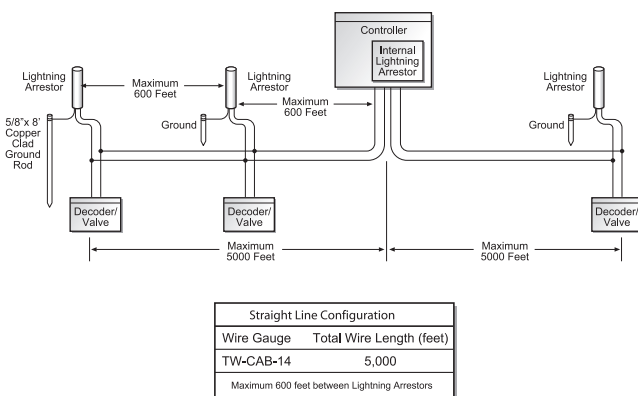

**Straight Line Configuration**

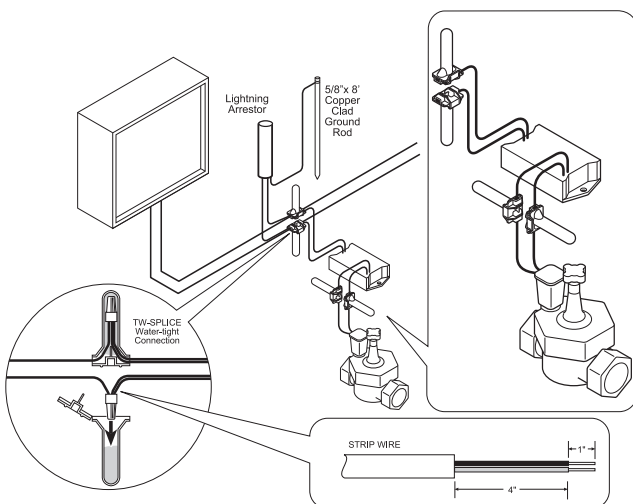

**Wire Connection Detail**

# EAGLE™ PLUS 2-WIRE



## TWICE™ 2-Wire

Unlike some other 2-wire systems, Twice protocol provides a 2-way communication link between the controller, decoders and valves.

- Provides 200 station two-wire capability (100 decoders max.)
- Intelligent "Plug-n-Play" modular design

## TWICE 2-Wire Decoders

- Easy-to-read LED status indication for every command
- LED also displays valve activation and diagnostic reporting
- Troubleshooting capabilities:
  - LED decoder "active" indication
  - LED valve power "on" indication
  - Two-way communication verification
- Each decoder has unique address
- Decoders will automatically shut off if communication is lost
- A short automatically shuts down any valve
- Valves can be operated up to 100' radius of the decoder

## Models

Model	Description
TW-D-1	1-station AC decoder
TW-D-2	2-station AC decoder
TW-D-4	4-station AC decoder
TW-LA-1	AC in-line surge protection
TW-CAB-14	14 AWG polycoated 2-wire
TW-SPLICE-14	14 AWG water-tight splices
TW-PROG	Portable decoder programmer



# iCENTRAL™

The patented iCentral is the first, most comprehensive and affordable web based water management system. It allows wireless central control for one or more Eagle™ Plus irrigation “field” controllers. The iCentral website utilizes reliable 2-way wireless communication from the internet to interface with each field controller and provides alert notifications for a variety of system conditions. An entire irrigation system, no matter how large, can be managed through iCentral.

## Notable Features

- ✓ Automatic Irrigation Scheduler (AIS) determines the optimal irrigation schedule based on seasonal, site-specific parameters: irrigation efficiency, soil texture, plant type, slope, precipitation, etc.
- ✓ Flow Managed Irrigation (FMI) calculates irrigation schedules based on available flow and water window.
- ✓ Designed as a Progressive Web Application (Web App) for a better mobile experience.
- ✓ Intelli-Sync™ - Intelligent synchronization monitors changes made at the controller and allows the iCentral operator to accept or reject the entry.
- ✓ ZipET Just enter the local zip code once, and local weather information is automatically sent to each controller every day.
- ✓ **Full mobile** compatibility with smart phones and tablets.
- ✓ Smart Alerts™ are sent by iCentral for all field alarms generated when a “fault” occurs; text messages are sent to cell phone and/or email address.
- ✓ Automatic initiation of “rain shutdown” to all controllers if iCentral determines that precipitation in a designated area necessitates a shutdown.
- ✓ Automatically modifies irrigation schedules based upon daily ET, as well as plant watering requirements.
- ✓ Variety of reports are available to show online and field activity, permitting detailed analysis of your system's efficiency.

## Flow Managed Irrigation (FMI)\*\*

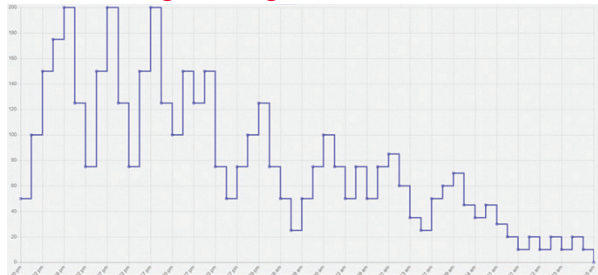

\*\* Graphs may vary as they are based on available flow, water window and programming constraints.



\* iPhone™ and the Apple logo are registered trademarks of Apple, Inc. in the U.S. and other countries.



\* Android™ and the Android™ logo are trademarks or registered trademarks of Google Inc.



## PROMAX™ Connect

The ProMax Connect App is a free cloud-based maintenance remote tool that allows users to operate stations and programs. With a simple and user-friendly interface, troubleshooting field issues can be performed with ease from your mobile device. ProMax Connect is available for download on the Google™ Play Store and Apple® App Store®.

## Additional Features

- ✓ Valid Program Activation
- ✓ Single or Multi-Station Activation
- ✓ Rain Hold Management
- ✓ Monitor and Manage Alerts
- ✓ View Local Weather in Real Time

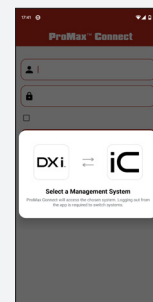
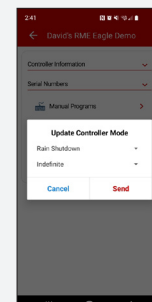
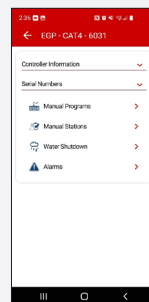

\*Google Play store and Apple App Store are trademarks or registered trademarks of their respective companies in the United States and other countries.

We reserve the right to improve our products and make changes in the specifications and designs without notice and without incurring obligation. Products depicted in this brochure are for demonstration purposes only. Actual products offered for sale may vary in design and features.



[www.toro.com](http://www.toro.com)

The Toro Company • Precision Irrigation Business • 5825 Jasmine St. • Riverside, CA • 92504 • 877-345-8676

Specifications subject to change without notice. For more information, contact your local Toro distributor. ©2025 The Toro Company. All rights reserved. PN: 25-1303-IRC