

LAC HCIB Service Kit

Installation Guide

Toro PN: 118-8254SK

TORO

Introduction

This service kit (118-8254SK) provides a replacement Hub Communication Interface Board (HCIB) assembly for LAC controllers. The models are:

- LAC-RS-1000-M
- LAC-RSB-1000-M
- LAC-RSP-1000-M
- LAC-RST-1000-M

Important Notifications



CAUTION: LAC serviceable parts shall be installed by qualified personnel familiar with the product and with local electrical code requirements. LAC serviceable parts shall not be used or installed in product other than LAC Product Series. Failure to do so will void product's safety and FCC certification. If used in product other than LAC Product Series, additional safety and FCC testing shall be considered as part of the end product assessment and usability.



CAUTION: Power off the controller prior to installing expansion kits.

Kit Components

- one (1) board assembly

Tools Needed

- Philips head screwdriver

Installation

1. Wallmount: Open the panel cover and door.
Pedestal: Open the lid and then front cover.
(Lifting the front cover up a little before pulling it makes it easier.)
2. Turn controller power off.
3. Remove ribbon cables (A) and power harness (B) from HCIB assembly.
4. Remove four mounting screws (C) and board assembly (D).
5. Install new HCIB (D) using four mounting screws (C).
6. Reconnect cables (A and B).
7. Turn controller power on and check communications with Central.
8. Close and secure wall-mount door panel or pedestal front panel.

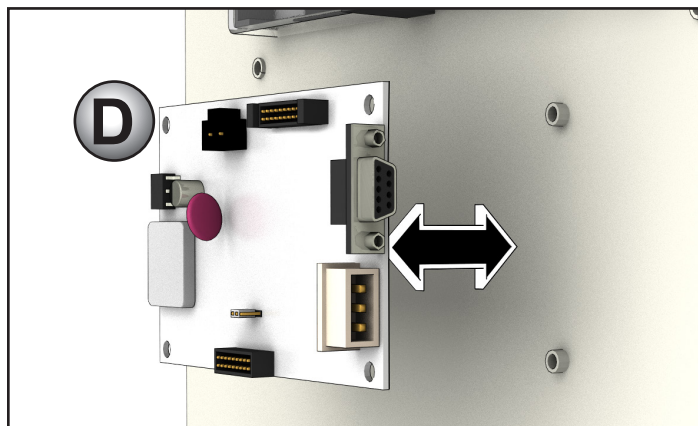
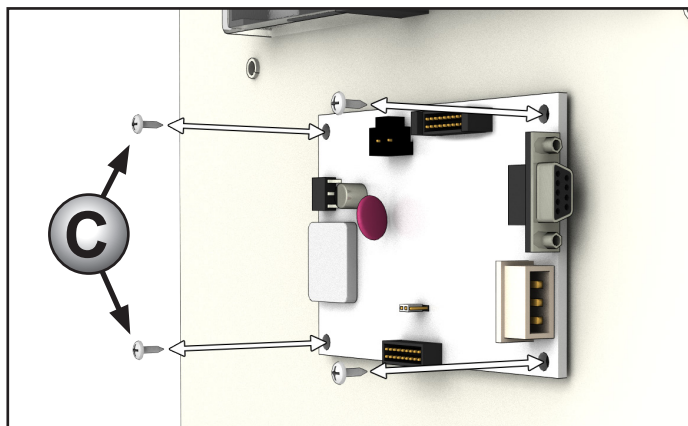
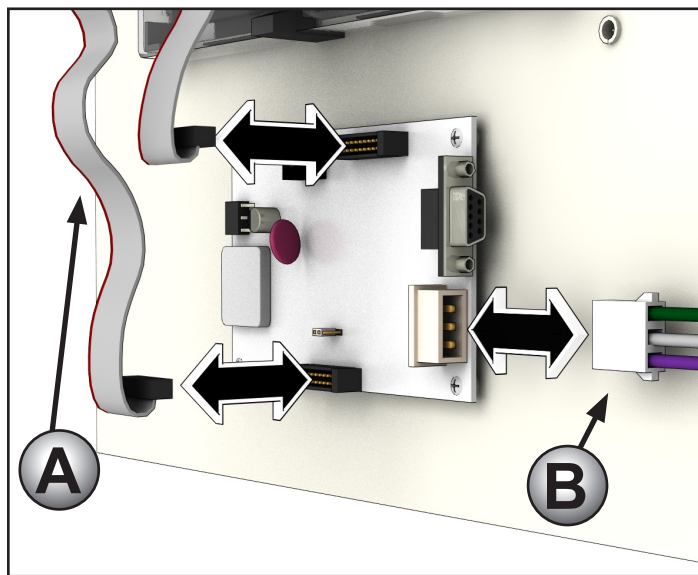



5825 Jasmine Street
Riverside, CA 92504
800-777-1477
irrigationsupport@toro.com



WARNING: Cancer and Reproductive harm – www.P65Warnings.ca.gov.
For more information, please visit www.toro.com/CAProp65.

Patent: www.ttcopats.com