

# LAC TM Service Kit

## Installation Guide

Toro PN: 118-8263SK

**TORO**

### Introduction

This service kit (118-8263SK) provides a replacement timer mechanism (TM) assembly for LAC controllers.

The models are:

- LAC-RS-1000-M
- LAC-RSB-1000-M
- LAC-RSP-1000-M
- LAC-RST-1000-M



**CAUTION:** Power off the controller prior to installing expansion kits.

### Wallmount Installation

1. Open the panel cover and door.
2. Turn controller power off.
3. Disconnect the two ribbon cables (A) from the TM, the ribbon cable (B) from the HCIB, and the Central communication cable (C) from the modem.

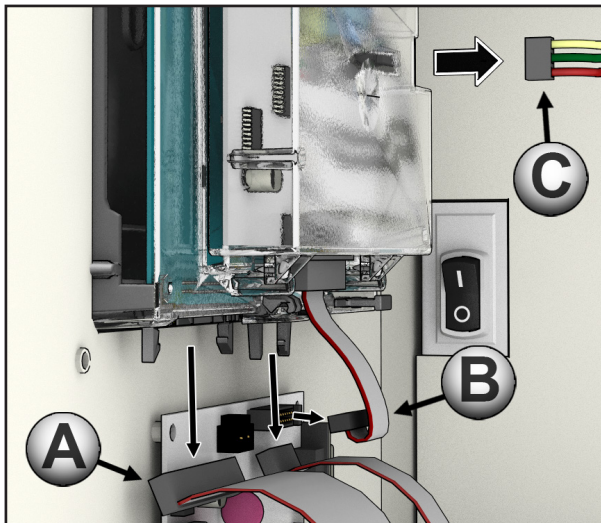

4. Remove the four mounting screws from the panel that secures the TM assembly, then remove the TM assembly.

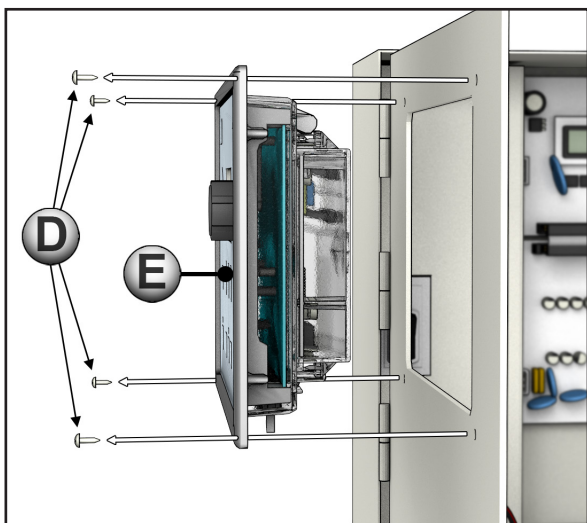

5. If the modem is to be transferred from the old TM assembly, remove the modem cover (F) and modem from the old TM assembly by removing the four screws (G) securing it to the back of the TM assembly.

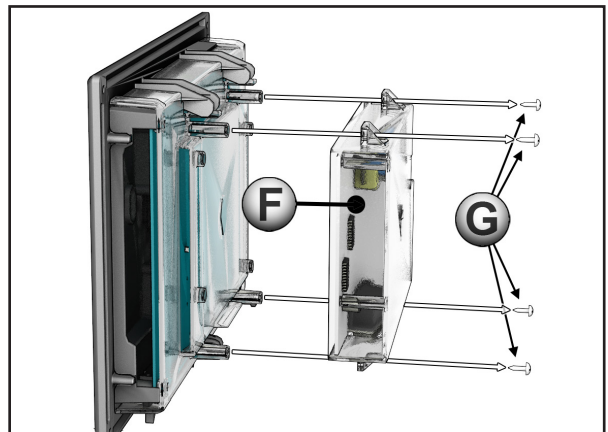

6. If you want to use the new modem cover, then remove the modem (H) from the old modem cover (F) and insert it into the new one. It can be lifted or pushed out of the cover. It helps to push on the Central three position communication connector (I).

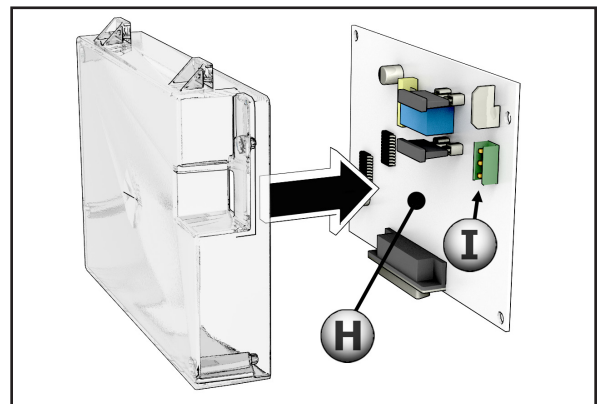

7. Install modem and cover on new TM using four screws.
8. It may be easier to install cables before securing the TM in the panel. If not, then install them after the next step.
9. Install new TM assembly on panel door using four mounting screws and reconnect any cables.
10. Check operation in the **Installation Confirmation** section.

## Pedestal Installation

1. Open the lid then remove front cover.
2. Turn controller power off.

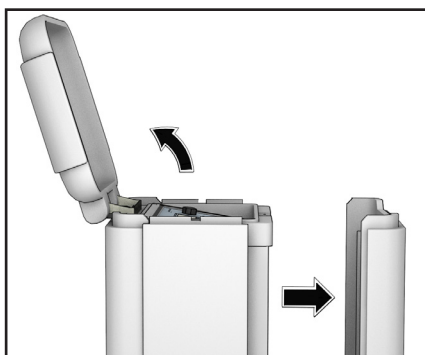

3. Disconnect the two ribbon cables (A) from the old TM (C).

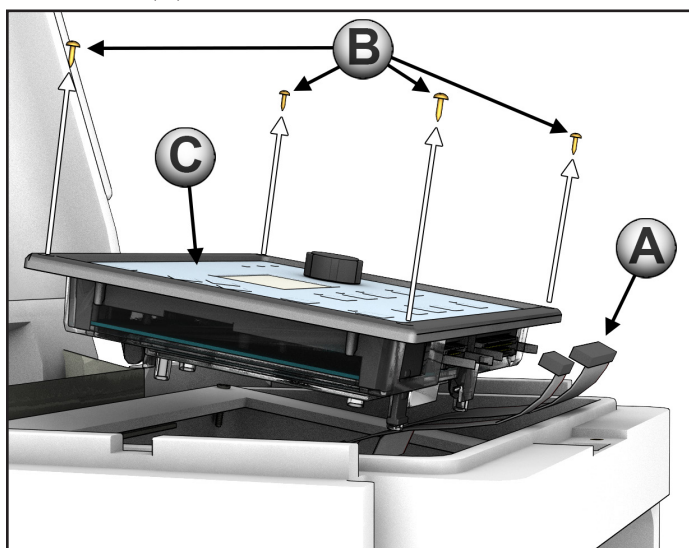

4. Remove the TM screws (B) then remove the old TM assembly.
5. Remove the modem cover (D) from the new TM assembly (E) by removing the four screws (F). The cover is not used on pedestals because the modem is installed elsewhere and it may get in the way.

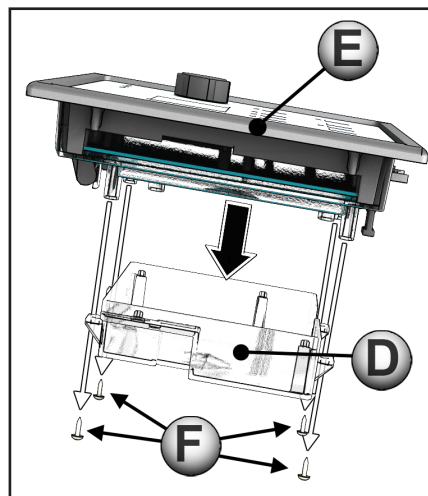

6. Install new TM assembly (E) using four mounting screws (B).
7. Reconnect ribbon cables. It might be easier to reconnect the ribbon cables before installing the new TM.
8. Check operation in the **Installation Confirmation** section.

## Installation Confirmation

1. Turn the power on and check TM detects the other boards correctly. The TM will display "Lynx Smart Hub LAC" on the home screen for an LAC unit.
2. Check TM firmware version by going to TM ► Diagnostics ► Revision. The firmware may be updated now if desired.
3. Power cycle controller if firmware was updated.
4. For Central systems, set CSG and Sat address in TM ► Unit Settings. Check TM ► Diagnostics ► Link Settings for additional Central communication settings. **Remap from Central.**
5. Close and secure wall-mount door panel or pedestal front panel.

## Kit Components

- one (1) board assembly

## Tools Needed

- Philips head screwdriver

## Important Notifications



**CAUTION:** LAC serviceable parts shall be installed by qualified personnel familiar with the product and with local electrical code requirements. LAC serviceable parts shall not be used or installed in product other than LAC Product Series. Failure to do so will void product's safety and FCC certification. If used in product other than LAC Product Series, additional safety and FCC testing shall be considered as part of the end product assessment and usability.



WARNING: Cancer and Reproductive harm – [www.P65Warnings.ca.gov](http://www.P65Warnings.ca.gov).  
For more information, please visit [www.toro.com/CAProp65](http://www.toro.com/CAProp65).